

Deform-Nut®

SERIE 9201 • 9201-Z

S E R I E S

THREADED TUBULAR RIVET NUTS WITH ROUND HEAD



APPLICATION

On boxed and tubular sections, metal sheets, other materials.

ASSEMBLY

By specific manual and pneumatic tools.

Ref. UNI 9201 standard

CODE		Grip range	Total length	Metrical thread	Shaft Ø	Head Ø	Head thicknesses	Hole Ø	Rear length
		(S)	(l)	(d1) 6H	(d)	(d3)	(l1)	(d5) +0,15 0	(l2) *
9201A/M 3/_	9201A/M 3/_Z_	0,5 ÷ 2,0	9,5	M 3	5	8	0,8	5	6
9201B/M 3/_	9201B/M 3/_Z_	2,0 ÷ 3,5	11						
9201A/M 4/_	9201A/M 4/_Z_	0,5 ÷ 2,0	10,5	M 4	6	9	0,8	6	6,5
9201B/M 4/_	9201B/M 4/_Z_	2,0 ÷ 4,0	12,5						
9201A/M 5/_	9201A/M 5/_Z_	0,5 ÷ 2,5	12,5	M 5	7	10	1	7	7
9201B/M 5/_	9201B/M 5/_Z_	2,5 ÷ 4,5	14,5						
9201A/M 6/_	9201A/M 6/_Z_	0,5 ÷ 3,0	16	M 6	9	12	1,2	9	9,5
9201B/M 6/_	9201B/M 6/_Z_	3,0 ÷ 5,5	18,5						
9201A/M 8/_	9201A/M 8/_Z_	0,5 ÷ 3,5	17	M 8	11	14	1,3	11	9,5
9201B/M 8/_	9201B/M 8/_Z_	3,5 ÷ 6,0	19,5						
9201A/M 10/_	9201A/M 10/_Z_	0,5 ÷ 3,5	21	M 10	13	16	1,5	13	12,5
9201B/M 10/_	9201B/M 10/_Z_	3,5 ÷ 6,0	23,5						
9201A/M 12/_	9201A/M 12/_Z_	0,5 ÷ 3,5	25	M 12	15**	18	2	15	16
9201B/M 12/_	9201B/M 12/_Z_	3,5 ÷ 6,5	28						

* Dimensions measured on average thicknesses. Variable according to s dimension.
**For the version with shaft diameter 16 refer to TC-TL pag 10

SERIES 9201 (lisci • plain)	
MATERIAL	
Steel nr. 1.0718	/8
Steel nr. 1.0303 (excluding thread M3 and M12)	/8S
Stainless steel nr. 1.4305	/X
Stainless steel nr. 1.4567 (excluding thread M3 and M12)	/XS
SURFACE TREATMENT	
Steel rivet nuts: white zinc plating	
Stainless steel rivet nuts: natural state	
THREAD TOLERANCE	
Metrica tolerance ISO 6H	
EXAMPLE OF CODE DESIGNATION	

Threaded tubular rivet nut with round head, grip thicknesses 2,0mm, M 6 thread, stainless steel material: **9201A/M 6/X**

SERIES 9201-Z (zigrinati • knurled)	
MATERIAL	
Steel nr. 1.0718	/8Z1
Steel nr. 1.0303 (excluding thread M3, M10 and M12)	/8ZS
Acciaio inox nr. 1.4305 Stainless steel nr. 1.0718	/XZ1
SURFACE TREATMENT	
Steel rivet nuts: white zinc plating	
Stainless steel rivet nuts: natural state	
THREAD TOLERANCE	
Metrica ISO 6 H Metrica tolerance ISO 6H	
EXAMPLE OF CODE DESIGNATION	

Threaded tubular rivet nut with round head and knurled body, grip thicknesses 2,0mm, thread size M6, stainless steel material: **9201A/M 6/XZ1**

For the versions B the knurling part might be detached from the head.

Non binding dimensions, expressed in mm.

9201

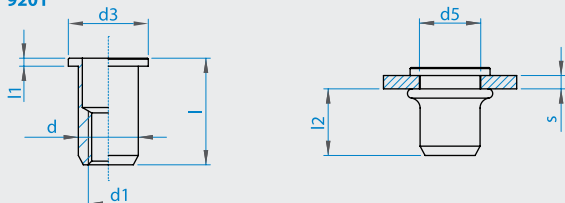

9201-ZS

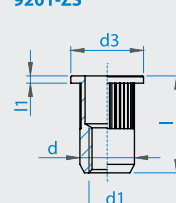

9201-Z1

